

T3N3 SERIES

Ø50mm Touch Beacon

Selection Guide

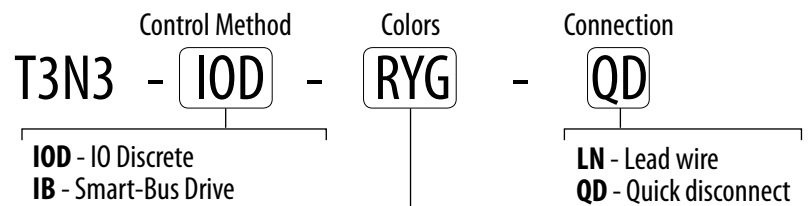
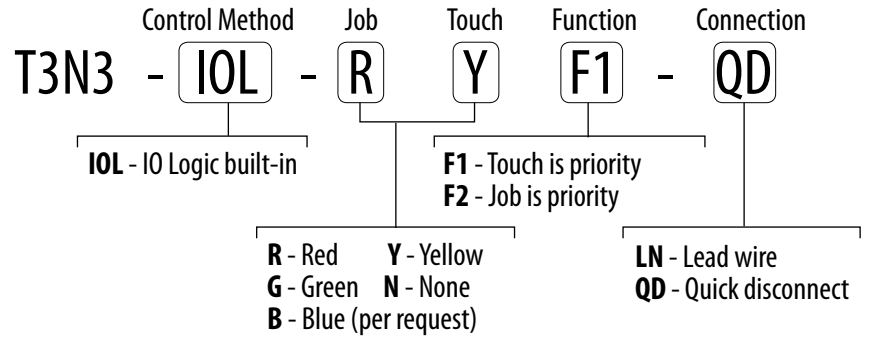

IOD - RYG Color order can be arbitrarily exchanged low (left) to high (right) priority.

* Blue available per request

IB - RGB (7 different colors controlled by software)



Specifications

Power supply	12V ~ 30V DC
Supply Current	Red, Green, Blue: <75mA(12V DC); <40mA(30V DC) Red, Cyan, Pink: <140mA(12V DC); <70mA(30V DC) White: <205mA(12V DC); <100mA(30V DC)
Output Current	Max. Load: 150mA Output state saturation voltage: Approx. equal to supply voltage Non-output state leakage current: <10µA(30V DC)
Function	F1: Job input keeps the "Job" light ON until touched. Touch activates output and overrides the "Job" light with "Touch" light F2: Job input keeps the "Job" light ON. Touch with inactive job input activates output and turns "Touch" light on
Electrical Protection	Reverse connection protection. Overcurrent protection
Input response time	on/off: 25ms max.
Connection	1m lead wire or 0.3m PVC cable with 4-pin or 6-pin M12 male quick disconnect (requiring mating cordset)
Operation conditions	-40°C to +50°C (-40°F to +122°F) 95% at +50°C maximum relative humidity (non-condensing)
Body material	Bases & covers: ABS(70%) +Polycarbonate (30%) Light segment: Polycarbonate
IP rating	IEC IP69K
Certification	CE, FCC

Dimensions

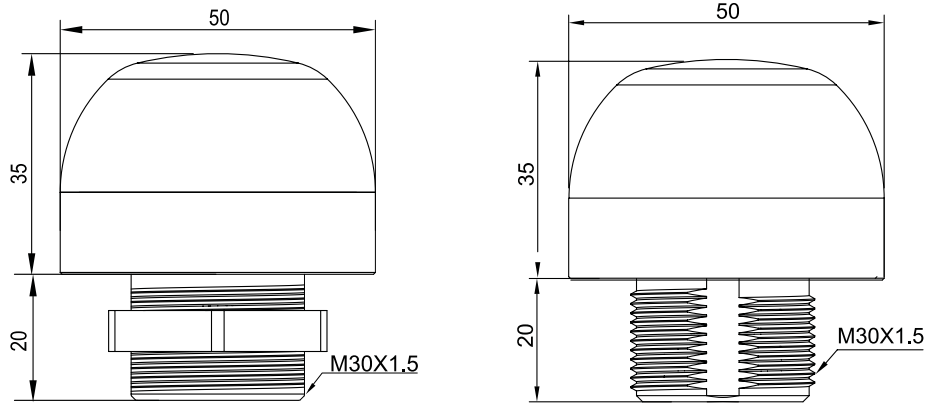

Wiring Diagram

T3N3-10

Line order	Line color	Note
1	Brown	Power +
2	White	Input
3	Blue	Power -
4	Black	Output
5	-	N/A

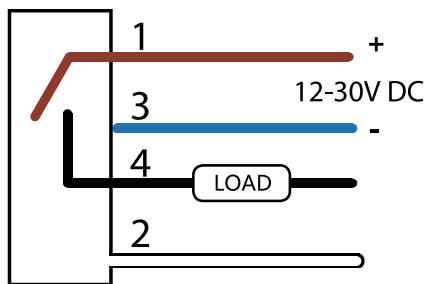

Quick Disconnect

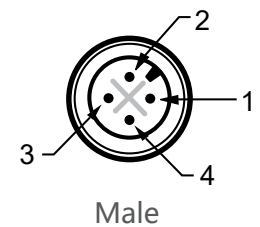

T3N3-1B

Line order	Line color	Note
1	Brown	Power +
2	White	IB +
3	Blue	IB -
4	Black	Power -
5	-	N/A

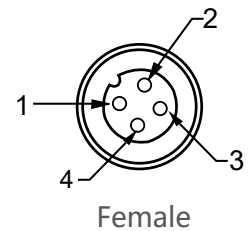
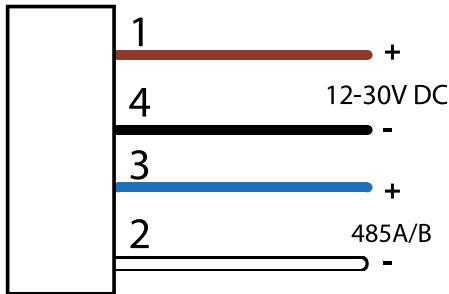

T3N3-10D

Line order	Line color	Light color
1	Black	Output
2	Brown	Power +
3	Green	Signal input
4	Yellow	Signal input
5	Blue	Power -
6	Red	Signal Input

